

INSTALLATION CAUTIONS

- Installation must conform to all local and state plumbing codes and regulations.
- Do not use with water that is microbiologically unsafe or of unknown quality without adequate disinfection before or after the system.
- Do not exceed Maximum Pressure = 100 psi (690 kPa). If water pressure surges, or will at any time exceed the 100 psi maximum, a pressure regulator must be installed before the filter (recommended regulator setting is 75 psi or less) along with a water hammer arrestor to prevent potentially damaging shocks caused by water hammer.
- Connect system to cold water supply only. Water temperature should not exceed 100°F/28°C. Do not subject the system to freezing temperatures
- Do not install system in direct sunlight or where system is exposed to harsh chemicals or may be subjected to being struck by moving equipment, carts, mops or any other item that may cause damage.
- ALLOW a minimum of 5" under the unit to allow for filter replacement.
- Do not run any tubing under or touching the oven
- Ensure that any part of the tubing does not come into contact with any heat source

SYSTEM SPECIFICATIONS

Maximum Pressure	:	100 psi/8.6 bar
Maximum Temperature	:	100°F (38°C), Min.: 35°F (2°C)
Connections	:	Inlet - 3/8" tube ; Outlet, Drain & Tank – 1/4" tube
Storage tank capacity	:	3.2 US gal (max) at 60 psi

FEED WATER QUALITY

Water hardness	:	Max 7 GPG
Iron	:	< 0.3 PPM
Manganese	:	< 0.05 PPM
Turbidity	:	1 NTU max
Oil, gases & bacteria	:	None



SYSTEM DIMENSIONS

Model	Unit Width (Inch)	Unit Height (Inch)	Unit Depth (Inch)
CORO_00N	16.5"	22.5"	6"

OPENING THE PACKAGE

The CORO system includes the following:

- The main wall-mount unit
- Storage tank
- 6 feet of 3/8" poly tubing
- 18 feet of 1/4" poly tubing
- Wall mounting washer strip and mounting screws



INSTALLATION

1. Unpack the filter system. Remove the wing nuts on the case and keep aside. Remove the tubing and mounting screw packages from the case.
2. Now remove both black sumps (520B) by turning 1/8 turn to left, then pulling away from head (2501). Remove cartridge models AC10G05N & MB10G01N by gently pulling away from head boss. Place the cartridges aside in a safe place until final assembly.



3. Locate best position for mounting unit on a wall near the combi-oven where it can be easily accessed for changing filters and other maintenance. **NOTE:** Leave minimum of 5 inches clearance below sumps to allow removal of cartridge for replacement.

Move the membrane housing down so that mounting hole is accessible. Now lift the unit close to the mounting location and mark the 2 top and bottom mounting holes. Depending on the mounting wall, you may need to pre-drill a hole or use appropriate anchors or different screws. Now mount the unit on the wall.



4. Remove the shrink wrap from the 2 pre-filters and re-attach them to the unit.
5. Re-attach the sumps and lock into position. **WARNING: TO AVOID CATASTROPHIC FAILURE, THE SUMP MUST BE TURNED FULLY TO LOCK POSITION**
6. Using the 3/8" tube provided, connect the water supply to the inlet of the unit.

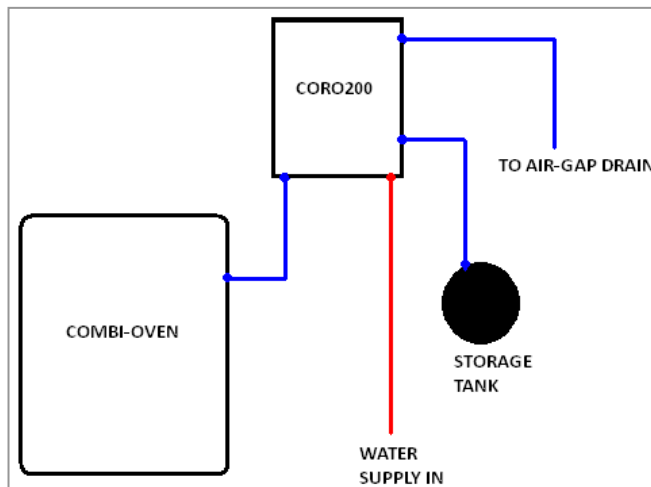

7. Using the 1/4" tubing provided, connect the drain port to an air-gap drain and the tank port to the valve on the storage tank. You can stand the tank on the floor anywhere near the unit (not more than 8 feet away). You may also rest it on an appropriate wall bracket or shelf.
8. Turn off the combi-oven to which the filter system is going to be attached.
9. Connect the outlet port of the unit to the appropriate feed water connection on the combi-oven.

10. Remove cover plate (2508) over electronic monitor by prying up gently with fingernails at front and back. Unwrap coin battery (2545) and insert positive (+) side up into battery slot between contacts. Re-install cover plate.
11. Slowly open the supply valve at the tap water source and check for leaks.
12. Replace unit cover and hand-tighten wing nuts.
13. Allow the tank to fill up for 2-3 hours before use.

OPERATION

The unit stores approx 3 US gal of water at full capacity. It takes about 1.5 to 2 hours to fill up the tank from empty. As the oven uses water, the unit makes water slowly and fills the tank back up. While the unit is making water, you will notice water also running down the drain. This is normal. When the tank is full, the unit will automatically shut-off and drain water will stop.

MAINTENANCE

The only routine maintenance is periodic filter cartridge changes or replacement of sump O-rings. Replace sump "O" rings (Part # 2502) once a year. The membrane life is dependent on feed water conditions and generally requires replacement between 1 to 4 years.

REPLACING THE PRE-FILTERS MB10G01N and AC10G05N

Filter cartridge changes are necessary for optimum performance of your foodservice equipment. The pre-filters MB10G01N & AC10G05N should be replaced once at least every 6 months on most tap water. However, cartridge life is directly dependent on water conditions and the volume of water filtered. Replacement may be required more frequently if water has excessive sediment.

- 1 Close the feed water valve and close the tank valve. Briefly turn on the combi-oven to release pressure inside the filter and quickly turn off. Press the pressure-relief button on top of the pre-filters to make sure that the pressure is fully released.
- 2 Once filter is fully depressurized, turn sump 1/8th turn to left and lower to remove. Remove old cartridge and replace with yellow gasket up. Replace sump and turn 1/8th turn to right fully to stop (lock position).
- 3 Remove post-filter by pressing the collet on the post-filter with 2 fingers and removing the tubing. Replace the post filter by simply pushing the tubing back in.
- 4 Open valve and allow water into the unit & then open the tank valve.

REPLACING THE RO MEMBRANES (Qty = 2 for CORO200 and Qty = 3 for CORO300)

Membranes usually last several years before requiring replacement. Replacement frequency depends on supply water quality and volume of water filtered over time. End of membrane life is indicated by increase in the permeate (product water) TDS (mineral content) or low or no filtered water flow.

CAUTION: All membranes must be replaced at the same time. Do not replace only one membrane as that will cause damage to it with significantly shortened life and poor water quality and flow.

To replace the membrane(s)

- Shut down the water supply to the unit
- Close the valve on top of the tank
- Open the combi-oven to de-pressurize the unit
- Disconnect the membrane INLET tube from fitting (2609) from the membrane housings (2601). Push the collet in with 2 fingers and pull tube out (See Fig.).
- Unscrew membrane housing cap and using pliers, pull old membrane out of housing.
- Unpack the new membrane and apply silicone lubricant (included with the membrane) on the two O-rings. Slide membrane into housing, "O" ring side first. Push membrane completely in until slotted end is flush with housing opening. If you cannot push the membrane fully in, pull it out and apply some more lubricant and repeat procedure.
- Replace housing cap & firmly hand-tighten. Insert membrane inlet tubing back into the housing inlet fitting (2609). Push tube firmly through collet 5/8" past O-ring until it seats on tube stop.
- Reconnect the membrane INLET tube to the 2609 fitting
- Repeat procedure for other membranes
- Slowly open the supply water valve and check for leaks. If any fitting leaks, shut the water off and push tube firmly back in past the "O" ring until it seats on the tube stop
- Turn storage tank valve one quarter turn left (counter-clockwise) to open. The handle should be in line with the tubing as it enters the connection.
- Your unit is now in operation.

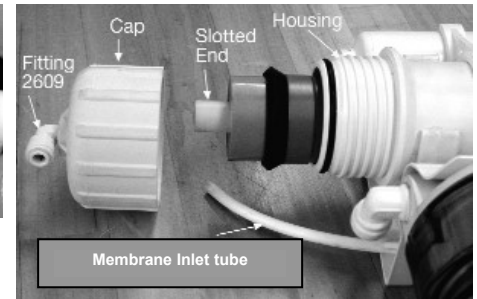
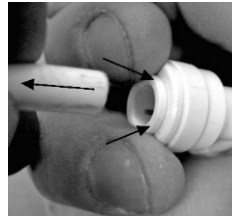

Limited One (1) Year Warranty

Envirogard system housings are warranted, to the original purchaser/owner, for a period of **one (1) year**, from the date of purchase, against defects in materials or workmanship. O-rings, and installation fittings are also warranted for a period of one (1) year from the original date of purchase. Envirogard's obligation under this warranty shall consist of repair, replacement or credit, at its option, of any part found by Company inspection to be defective, provided that the product has not been misused, abused, altered or damaged as determined by the Company and provided that only approved Nimbus replacement cartridges have been used in the housings. This warranty does NOT apply to the replacement cartridge(s), which by nature will diminish in performance through normal use and require(s) regular replacement.

